

METALWORKS®

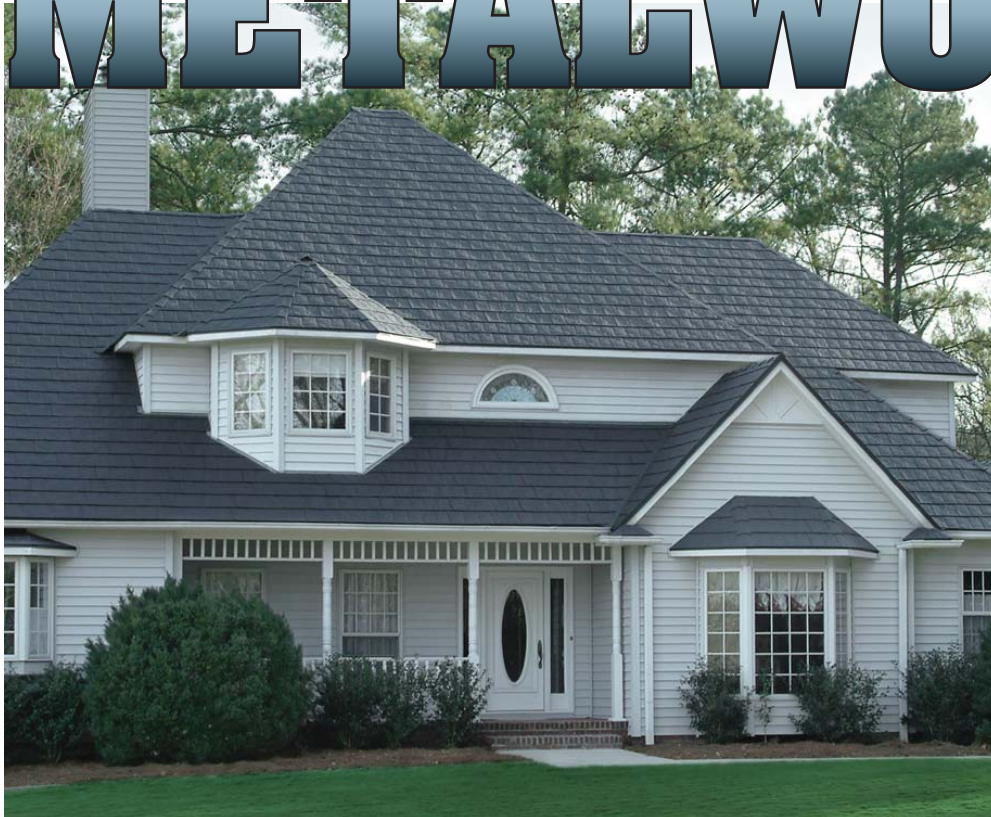

Steel Shingles

There's nothing quite like them.

METALWORKS® Shingles offer you an unsurpassed combination of aesthetics and performance. Available in three styles and a full array of colors, they are the ideal choice for a wide range of residential and commercial applications.

Features

- **G-90 Steel Construction**
Recognized as the industry standard
- **Kynar® 500 / Hylar 5000® Finish**
Resists fading and chalking
- **Perfect for Reroofing Applications** and can be installed over up to two layers of asphalt shingles*
- **Better for the Environment**
100% recyclable and made from up to 50% recycled material
- **50-Year Limited Warranty**
from TAMKO for your peace of mind
- **4-way Locking System**
for enhanced performance

METALWORKS® and TAMKO® are registered trademarks of TAMKO® Roofing Products, Inc.
Kynar® is a registered trademark of Arkema, Inc.
Hylar 5000® is a registered trademark of Solvay Solexis, Inc.

*Check your local Building Code. Building Code restrictions may apply.

3 Styles to Choose From

ASTONWOOD™ Steel Shingles create the traditional look of real wood shingles, yet are much more durable than wood to assure years of lasting beauty.

STONECREST™ SLATE Steel Shingles create a dramatic look that closely replicates the random finish of natural slate. They're made with a heavier gauge steel and double stamped for stunning beauty and durability.

STONECREST™ TILE Steel Shingles create the distinctive look of smooth, uniform tile. For those who appreciate a classic, refined appearance, these shingles provide outstanding performance and value.

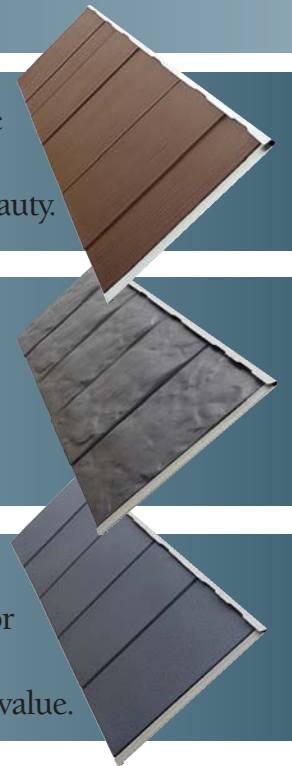

www.metalworksroof.com

800-641-4691
www.tamko.com

METALWORKS®
STEEL SHINGLES
220 West 4th St. Joplin, MO 64802
TAMKO®
ROOFING PRODUCTS

METALWORKS® STEEL SHINGLES



ASTONWOOD™

Colors, Profile & Physical Data



Forest Green River Rock Brown Sequoia Red Sierra Slate Grey Timber Brown Vermont Blue Brite Red

- Painted Galvanized Steel
- Minimum slope: 3" in 12"
- Shingle width-overall: 39-3/4"
- Shingle height-overall: 12-5/8"
- Shingle Exposure: 12"
- Shingles per box: 30 panels
- Coverage per box: 98.5 sq. ft. (Approx. 1 square)
- Weight per shingle: 2 lbs.
- Weight per square: 61 lbs.
- Shingle Material: Nominal 0.0135" thickness including G-90 galvanization and paint coatings. Exterior finish is fluoropolymer (PVDF) with anti-corrosive primer, 1 mil dry film thickness. Interior finish is a wash coat with anti-corrosive primer, 0.6 mil dry film thickness.
- Clip: 1-1/4" wide x 2-1/8" long x 0.20" deep.
- Clip Material: 0.015" thick, G-90 galvanized steel.



**STONECREST™
SLATE**

Colors, Profile & Physical Data



Quaker Green Sierra Slate Grey Vermont Blue Sequoia Red

- Minimum slope: 3" in 12"
- Shingle width-overall: 39-3/4"
- Shingle height-overall: 12-5/8"
- Shingle Exposure: 12"
- Shingles per box: 15 panels
- Coverage per box: 49.2 sq. ft. (Approx. 1/2 square)
- Weight per shingle: 2.5 lbs.
- Weight per square: 74 lbs.
- Shingle Material: Nominal 0.0162" thickness.
- Clip: 1-1/4" wide x 2-1/8" long x 0.20" deep.
- Clip Material: 0.015" thick, G-90 galvanized steel.



**STONECREST™
TILE**

Colors, Profile & Physical Data



Quaker Green Sierra Slate Grey Vermont Blue

- Minimum slope: 3" in 12"
- Shingle width-overall: 39-3/4"
- Shingle height-overall: 12-5/8"
- Shingle Exposure: 12"
- Shingles per box: 15 panels
- Coverage per box: 49.2 sq. ft. (Approx. 1/2 square)
- Weight per shingle: 2.5 lbs.
- Weight per square: 74 lbs.
- Shingle Material: Nominal 0.0162" thickness.
- Clip: 1-1/4" wide x 2-1/8" long x 0.20" deep.
- Clip Material: 0.015" thick, G-90 galvanized steel.

All values stated as nominal

METALWORKS® Steel Shingles and Accessories

ASTONWOOD™ Steel Shingle

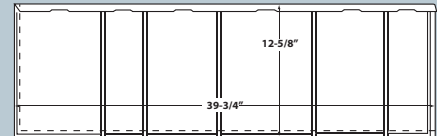

STONECREST™ SLATE & STONECREST™ TILE Steel Shingles

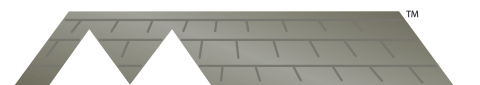
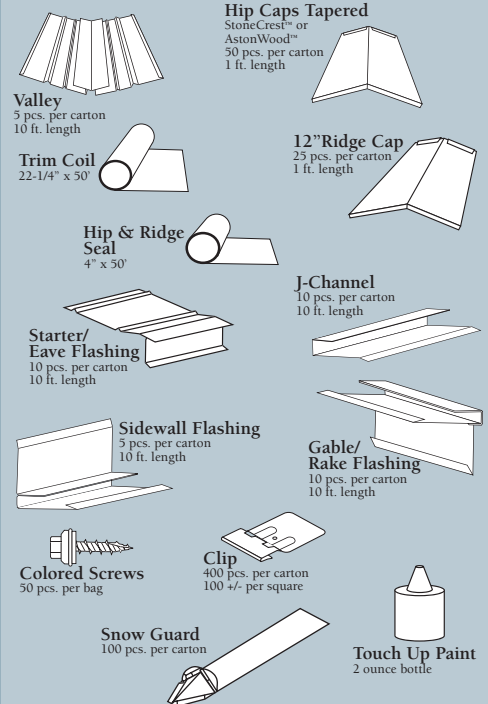
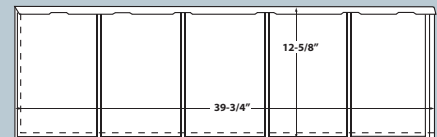

METALWORKS®

STEEL SHINGLES **TAMKO** ROOFING PRODUCTS

